

RECAPE ASFÁLTICO DA RUA PERNAMBUCO - TRECHO COMPLETO

Trecho entre a rua Ceará e Avenida Paraná
Escala:.....1/750

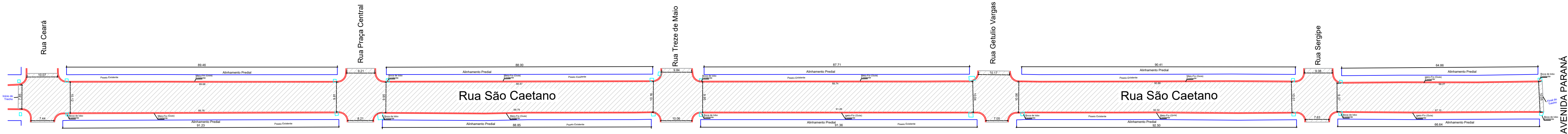
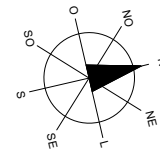

RECAPE ASFÁLTICO - TRECHO 1

Trecho entre a rua Ceará a Treze de Maio
Escala:.....1/500

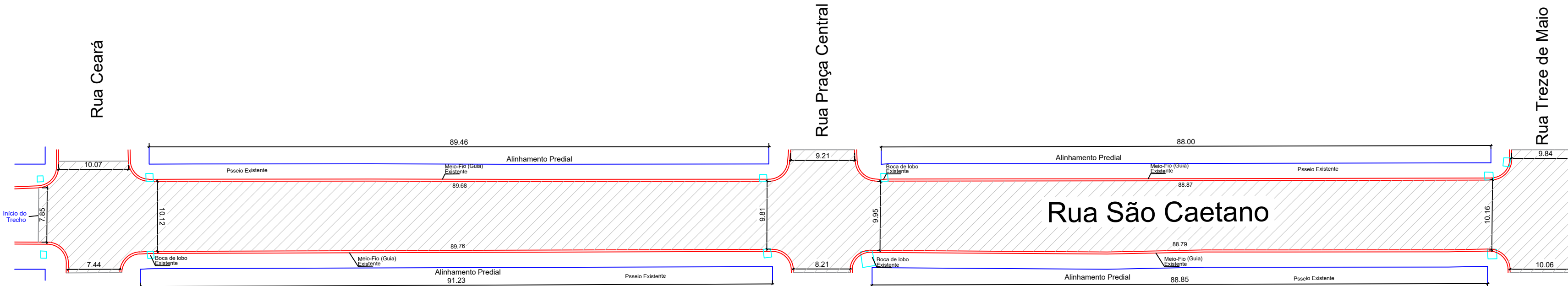
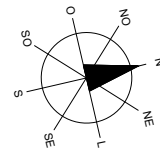

LEGENDA:

- MEIO - FIO ALTO EXISTENTE
- GALERIA EXISTENTE
- ÁREA DE RECAPE SOBRE PEDRA IRREGULAR= 5.365,91 M2
- PINTURA AMARELA = 956,00 m
- PINTURA BRANCA = 342,00 m2

RECAPE ASFÁLTICO - TRECHO 2

Trecho entre a rua Treze de Maio e Avenida Paraná
Escala:.....1/500

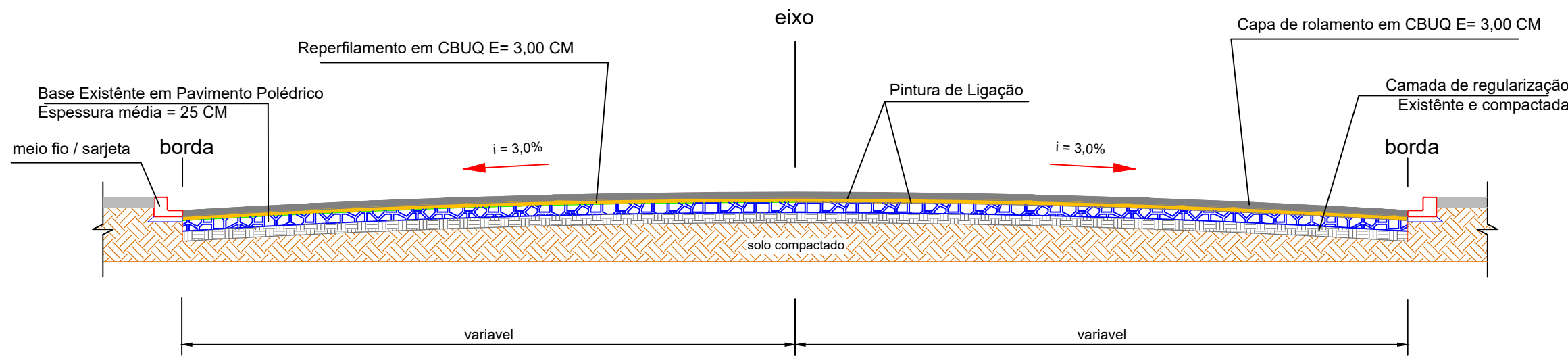
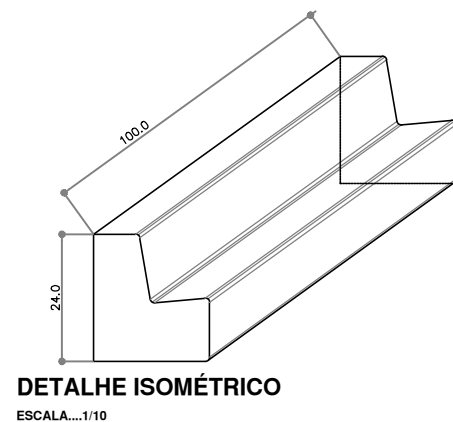
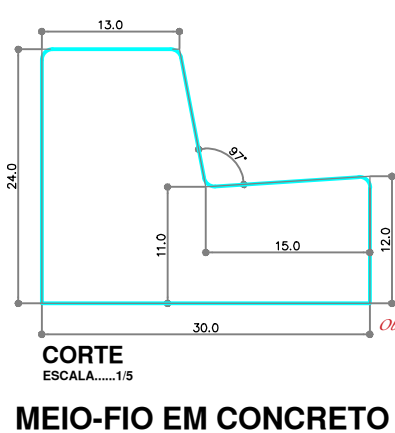
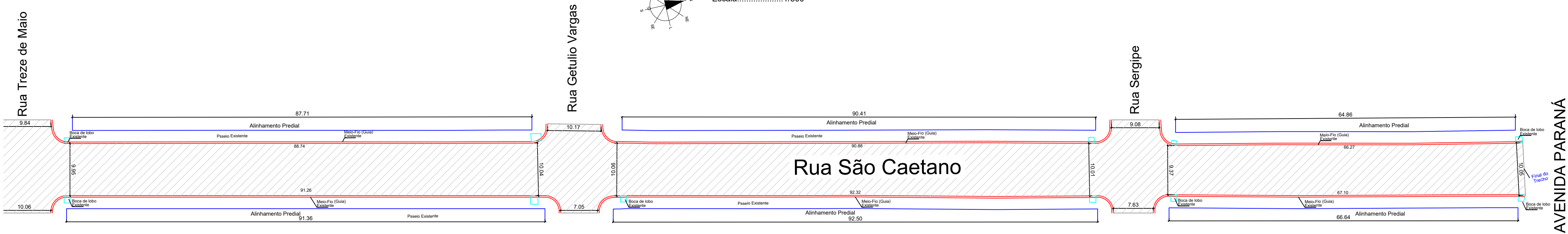
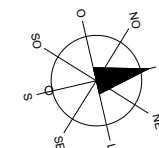



MUNICÍPIO DE LARANJAL
DEPARTAMENTO DE ENGENHARIA E ARQUITETURA

OBRA:

REFERÊNCIA:

PROJETO DE RECAPE SOBRE PEDRA IRREGULAR NA RUA SÃO CAETANO

DESENHO:

PAULO H.

DATA:

23/05/2022

ÚLT. REVISÃO:

20/05/2022

ESCALA:

INDICADA

FOLHA:

02/07

PROPOSITOR:

RESP. TÉCNICO:

João Elinton Dutra
Prefeito Municipal

Paulo Henrique Rodrigues Medeiros
Engenheiro Civil CREA-PR 168345/D